



Front view

HDSRDCLC-71-LE



Rear view



Lower Refrigerated Storage Compartment

STANDARD FEATURES

- Double duty deli cases offer two refrigerated compartments. One for display for ready to serve deli products, and a second lower compartment for storage.
- Interior: Aluminum liner with stainless steel floor.
- Exterior: Black or white coated steel. Stainless steel available.
- Anti-Fogging Low E Glass
- Rounded corner design inside of the cabinet makes it easy to clean the inside storage room.
- Refrigeration system keeps the meats and deli products at safe temperatures between 38°F and 40°F (3.3°C to 4.4°C).
- Preinstalled 4” heavy-duty casters with brakes.
- Electronic control system makes it easy to adjust temperature set point and defrost frequency.
- Slide out refrigeration condensing unit makes it easy to access condenser for cleaning and service.
- Shelves: Adjustable stainless steel shelves.
- LED interior lighting.
- These units use HYDROCARBON R290 refrigerant, which is environmentally friendly and more efficient than R134a/R404a refrigerant.

HDSRDCLC-50-LE

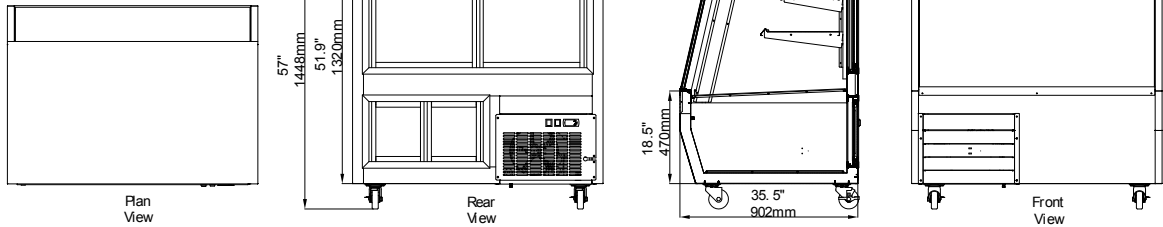

HDSRDCLC-71-LE

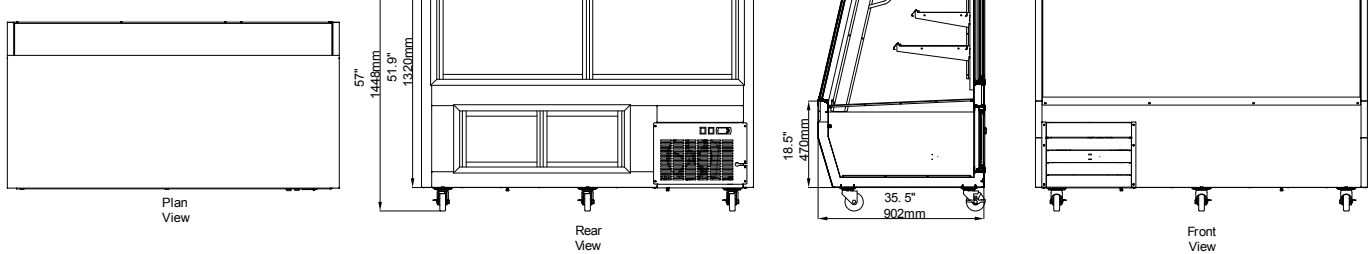

HDSRDCLC-84-LE

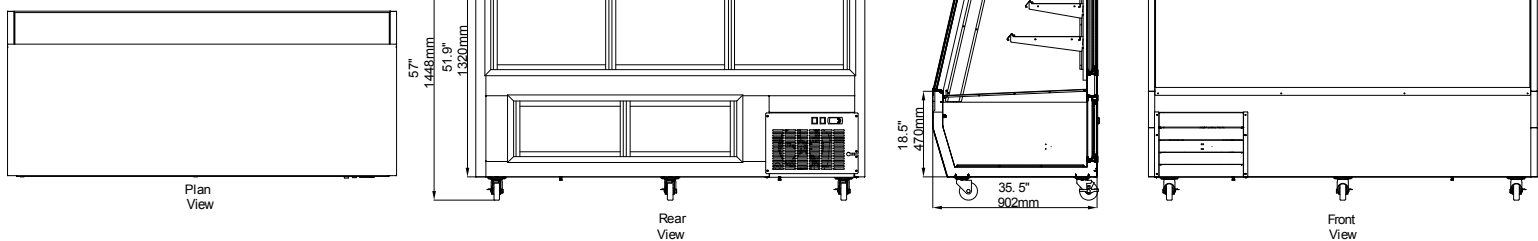

MODEL	DOORS	SHELVES	DIMENSIONS	CAPACITY	HP	AMPS	VOLTAGE	PLUG TYPE
HDSRDCLC-50-LE	2	2	50 x 35 1/2 x 57 in 1270 x 902 x 1448 mm	26.72 cu.ft.	4/5	4.4	115/60/1	NEMA 5-15P
HDSRDCLC-71-LE	2	4	71 x 35 1/2 x 57 in 1805 x 902 x 1448 mm	41.37 cu.ft.	1	7.3	115/60/1	NEMA 5-15P
HDSRDCLC-84-LE	3	6	84 x 35 1/2 x 57 in 2135 x 902 x 1448 mm	50.42 cu.ft.	1	10.2	115/60/1	NEMA 5-15P

sales@heavydutysystems.com

Voltage 220/50/1 available.