

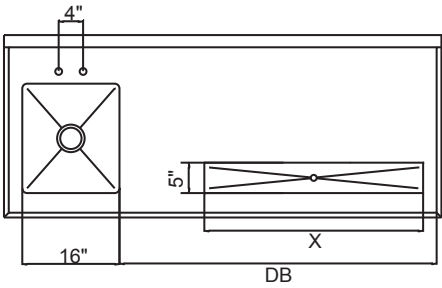

SBC3

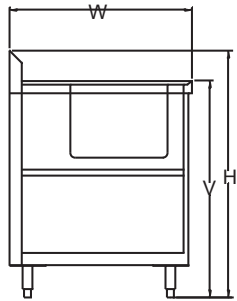

SBC3-R



SBC3

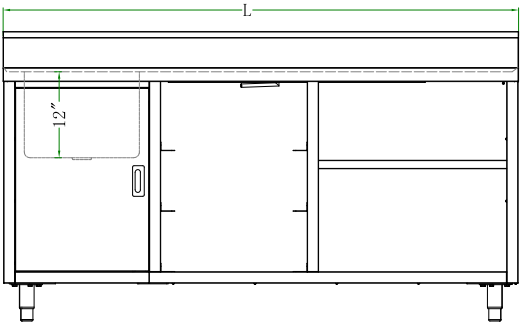
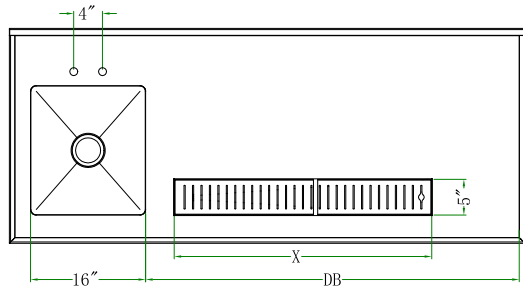
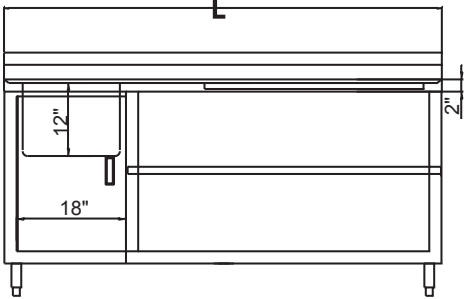

SBC3-R

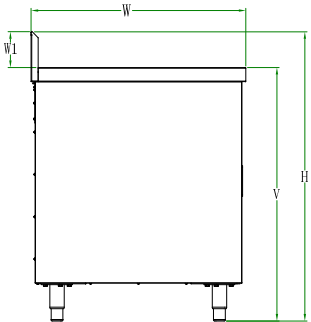

Optional:
With slides in middle(R)
For example: SBC3-3048B5R

MODEL	O.A.Dims - in.				Packing Dims - mm			CBM
	L	W	H	DB	V	w1	H	
SBC3-3048B5L/R	48	30	40-1/2	29	35-1/2	5	18	0.930
SBC3-3060B5L/R	60	30	40-1/2	41	35-1/2	5	24	1.157
SBC3-3072B5L/R	72	30	40-1/2	53	35-1/2	5	36	1.384
SBC3-3084B5L/R	84	30	40-1/2	65	35-1/2	5	48	1.611
SBC3-3096B5L/R	96	30	40-1/2	77	35-1/2	5	60	1.837
SBC3-3048B5RL/R	48	30	40-1/2	29	35-1/2	5	18	0.930
SBC3-3060B5RL/R	60	30	40-1/2	41	35-1/2	5	24	1.157
SBC3-3072B5RL/R	72	30	40-1/2	53	35-1/2	5	36	1.384
SBC3-3084B5RL/R	84	30	40-1/2	65	35-1/2	5	48	1.611
SBC3-3096B5RL/R	96	30	40-1/2	77	35-1/2	5	60	1.837

sales@heavydutysystems.com

STRUCTURE AND FEATURES

- 300 series stainless steel top and bowl. 400 series stainless steel body
 - Top is mechanically polished to a stain finish with no welded seams, 5"x2" back splash
 - 16"x18"x12" welded bowl built into the cabinet top, 4" OC faucet holes opened
 - 5" wide drain plate
 - Adjustable intermediate shelf equipped for convenient storage space
- Stainless steel Legs with adjustable feet
 - SBC3-R includes rack slides in middle cabinet
 - Must specify sink location (Left or Right) when ordering
- PACKAGE

 - Legs can be knocked-down for saving space
 - Economic bubble package