

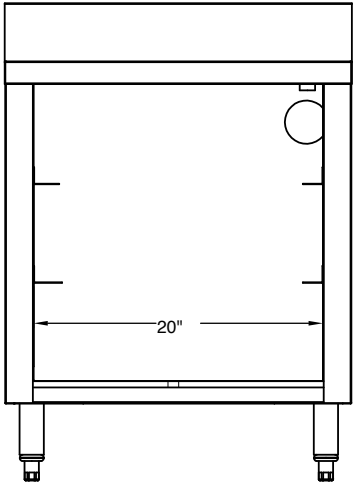

CGRC-2124

STRUCTURE AND FEATURES

- NSF certification for food service application
- 300 series Stainless steel embossed drain board
- 400 series Stainless steel body
- 4” high backsplash
- Support 3 pieces of 20”x20”x4” glass rack
- Stainless steel heavy duty legs with adjustable feet

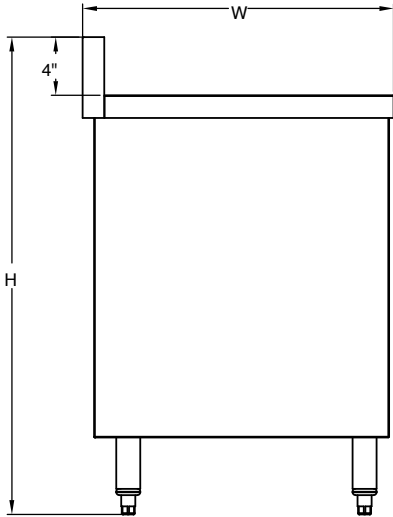
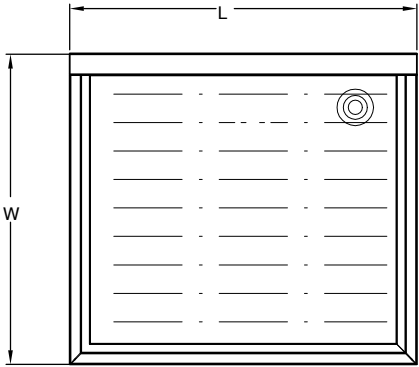

MODEL	O.A.Dims - in.			Packing Dims - mm			CBM
	L	W	H	L	W	H	
CGRC-2124	24	21-1/2	33	620	580	625	0.225

sales@heavydutysystems.com